



*Ell Villa*



*Ell Villa*

*.....bespoke villa design by Deborah Ell*



*Tel: 01908 670132 | Mob: 07746066144  
deborah@ellvillacreations.com*

*www.ellvillacreations.com*

*Ell Villa Creations Ltd - Co Reg No 08187650  
Registered in England & Wales*

*Registered office address: 25 Warmington Gardens, Downhead Park, Milton Keynes, MK15 9BP*

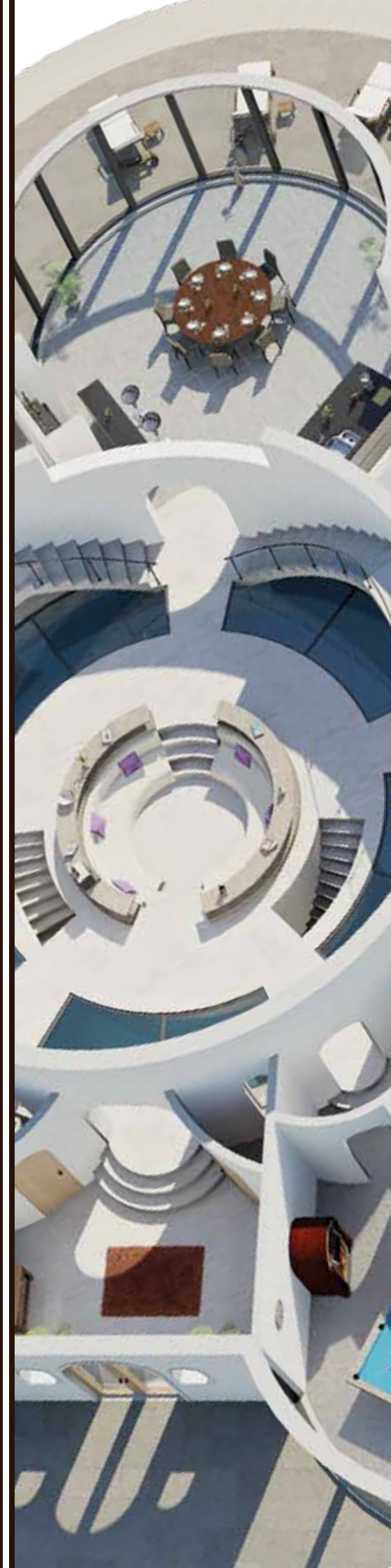





# Ell Villa

## KEY POINTS OF THE PROTECTED 5 PETAL FLOWER DESIGN ARE AS FOLLOWS

- Swim from any room for a serious work out or just for fun!
- Central Atrium full of light, rippling water reflections and curves
- Can be one or two storeys
- Can be scaled to provide any room size required
- Exterior can be customised to suit location e.g. white render, coloured resin, Portland stone, Cotswold stone

The shape can be replicated to form as many connecting wings as required e.g. bedroom wing, equestrian wing with a central ménage under the dome. Or each petal could be an apartment. Lends itself well to spa and hotel buildings too.

Each petal can be configured to any room required. One petal could be a master suite containing a bathroom, dressing room and stairs to a roof terrace and steps down into the underground swimming channel. One petal could be a kitchen and dining room accessed via a wide archway off the central atrium. The options are endless.

In the centre of the atrium is a sunken 12 ft diameter circular seating area with bespoke settees built into the circle; a place to sit and chill, look up through the dome at the sky and stars at night. Three steps lead down into the seating area whose perimeter is also surrounded by bespoke circular units containing filtered cold water tap, coffee machine, drinks cabinet, music and lighting controls, wine fridge etc.

Beneath the central atrium is a basement room within the middle void of the swimming pool, accessed by stairs from the central atrium. This can be used as a cinema room or a gym or a recording studio, or whatever is desired. The cinema room could have a fibre optic star effect ceiling and walls so that it feels as if you are watching movies under the stars. There could be swimming channel viewing panes in the walls – the ideal place to stage a synchronised swimming display for your guests!



**T**he underground 8ft wide circular swimming channel is glass ceiled, forming part of the floor in the double height central atrium. In the day, light will stream in through the dome and down through the glass roof of the swimming channel, casting rippling water reflections back up over the atrium walls.

**A**t night, mood lighting and fibre optics will create a sensory experience. The swimming channel can be optionally accessed via descending marble steps from the bedrooms or indeed any room, even a slide from the first floor bedrooms. The steps would be accessed via an access coded partitioning door from the bedroom. It is also a lazy river so that you can swim with the flow or against. The flow can be increased to form waves for fun. It leads to an outdoors Jacuzzi area and then down a water chute, tastefully blended into the outdoor landscaping, to an outdoor swimming pool. Landscaped steps run back up alongside the chute. Aerially the chute and stairs form a stem and the leaf at the bottom is the swimming pool.

**A**nother leaf could be tennis court, or a crazy golf course, or a bowling green etc. Endless circuits can be swum around the swimming channel (or figures of 8 if there are two wings), clockwise or anti clockwise, with the flow or against the flow and then out into the water chute, down to the swimming pool, back up the steps and around again as many times as desired; A huge fun way to work out aerobically straight from the bedroom.

The design could incorporate solar glass, either the central dome, or part of the petals. Possibly backlit with led lighting that could be mood control colour changed at night to light up patios and alter appearance aerially. Part of the ceiling could be missing in the petal rooms to reveal the glass above.

.....



# THE INSPIRATION

Whilst staying in a Portuguese villa in 2006 and reading *The Da Vinci Code* I was inspired by the quotation below. My imagination set to work to combine the two beautiful forms of a villa and a rose as one beautiful creation.

## Dan Brown's "The Da Vinci Code" :

"Rosa Rugosa, one of the oldest species of rose, had five petals and pentagonal symmetry, just like the guiding star of Venus, giving the Rose strong iconographic ties to womanhood. In addition, the Rose had close ties to the concept of 'true direction' and navigating one's way. The Compass Rose helped travellers navigate, as did Rose Lines, the longitudinal lines on maps. For this reason, the Rose was a symbol that spoke of the Grail on many levels, secrecy, womanhood, and guidance, the feminine chalice and guiding star that led to secret truth."

## More from "The Da Vinci Code":

"The Rose has ties to the five pointed pentacle of Venus and the guiding Compass Rose. The word rose is identical in English, French, German, and many other languages. Rose is also an anagram of Eros, the Greek god of sexual love. The Rose has always been the premiere symbol of female sexuality. In primitive goddess cults, the five petals represented the five stations of female life; birth, menstruation, motherhood, menopause, and death. And in modern times, the flowering rose's ties to womanhood are considered more visual."



## Further research led to:

*A Cosmic Order (extract from THE VENUS PENTAGRAM by Laura Perkins)*

"One of the most convincing proofs ever encountered that there is a divine order to the universe, and that astrology is one of many ways it is revealed to the seeker, can be stated in simplest form in a single prime number. That number is 5.

*5 petals of the apple blossom, the cherry blossom, the columbine, the buttercup, or the wild rose. 5 points of the human body, as illustrated by Leonardo Da Vinci in his Vitruvian Man. 5 fingers. 5 toes. 5 senses. The fifth element. 5 elements in Chinese tradition. The Pentagram that the planet Venus, working with our Sun, draws in the heavens over time.*

**The cosmic fivefold** - Hidden within it is the heavenly expression of the Pythagorean mathematical concepts of the golden ratio, the divine proportion, known to mathematicians as the number PHI (1.618), which is found throughout nature and in turn has inspired some of humanity's greatest artists and architects. The Venus Pentagram is a natural phenomenon to others. It proves something extraordinary is happening outside the bounds of our everyday consciousness - wondrous and awe inspiring."

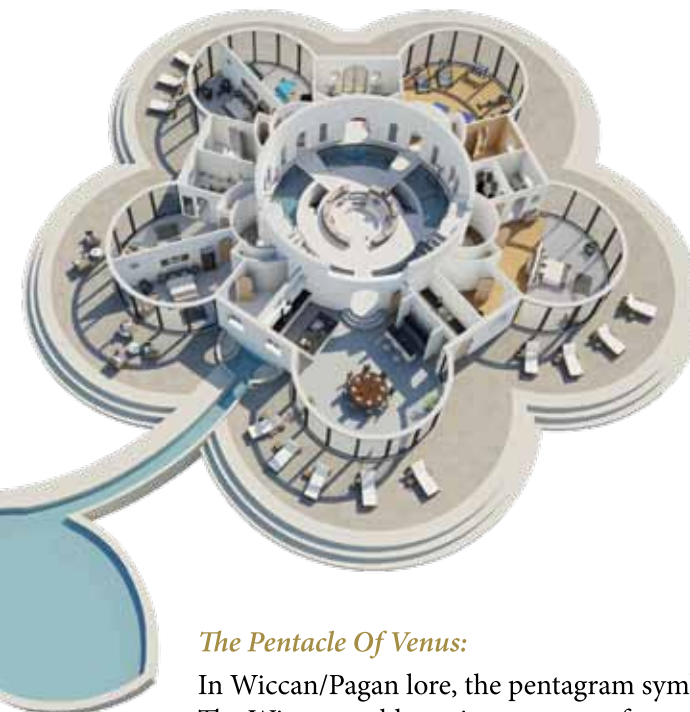

## The Pentacle Of Venus:

In Wiccan/Pagan lore, the pentagram symbolises the five elements- earth, air, water, fire, and spirit. The Wiccan emblematic pentagram faces point upward to symbolise the triumph of spirit over matter.

Roof terrace could incorporate walk on solar panels (Onyx Solar - Building Integrated Photovoltaics (BIPV) - Photovoltaic Glass for Buildings - Photovoltaic Building Materials - Green Building)

Patio doors slide back into wall cavity. Circular openings lead from the central atrium to each sunken petal inner hallway. There could also be obscure glass panels either side of the opening to light up the pool stair wells.

The surrounding exterior perimeter steps form flowing waterfalls and scented plant beds. Underground garage with access to plant room and rain and grey water stores underneath the petals. Drive could also form a stem when viewed aerially.

Heat exchange system takes hot air out of swimming channel and feeds fresh air back in to desired temperature, glass for ceiling would need to be anti-condensation. Under floor heating, ICF construction for thermal and acoustic properties.

Suggested finishes for show design: polished concrete floor or Franco microcement, polished marble walls or Franco microcement, aqua or deep blue coloured glass, double sweeping stone staircase sweeps up to upper balcony. Plastered swimming wall sides per Franco Finishes (Specialist plasters and renders). White render to external walls.

Two other protected variations of the design are available as:

A pentacle with the outer circle being an outdoor swimming pool.

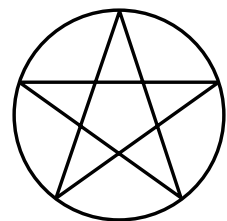

A 5 pointed star



The square footage of the villa shown here is approximately:

Ground Floor (Internal) 5394 sqft,  
First Floor (Internal) 2551 sqft,  
Total (Internal) 7945 sqft

The pattern on the central dome is the transit of venus.



**M**any ancient civilizations such as the Mayans, Greeks, Egyptians and Sumerians all knew that the planet Venus traced a Pentacle in the sky via a regular transiting cycle. The Pentacle pattern of Venus became ingrained into their mysticism and some of their ceremonies. The alchemists of days of old were not only wizards but also scholars. Central to their studies was the mastery of astrology and the examination of the paths the planets took as they moved through the sky. Of particular interest was the Pentacle of Venus and the magical influence they believe it held in the cosmic order of things. Amulets inscribed by the alchemists with the Pentacle were believed to help the wearer obtain grace and honour and to accomplish the heart's desire. The Pentacle of Venus also held special meaning for the Knights Templar which is evidenced in the popular writings and movies of the current day. The first astronomical telescopic observations of the Venusian cycle were conducted by Galileo.

*Let my imagination create your dream villa!*

**Deborah Ell**

[deborah@ellvillacreations.com](mailto:deborah@ellvillacreations.com)

[www.ellvillacreations.com](http://www.ellvillacreations.com)

